

Prairie Village Community Center Campus

Community Meeting Three
October 15, 2024

Introductions



PRAIRIE VILLAGE
KANSAS



JOHNSON COUNTY
KANSAS
Library

bnim + DAKE | WELLS
architecture + PARSON
+ ASSOCIATES 

Project History

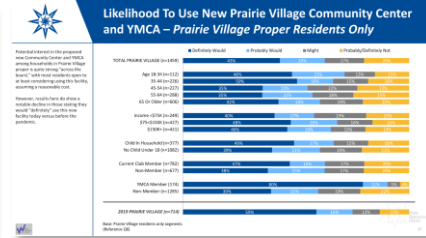
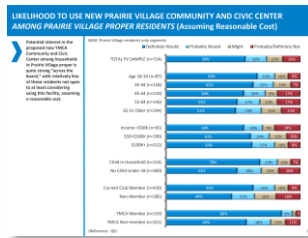
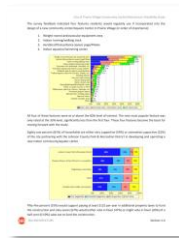
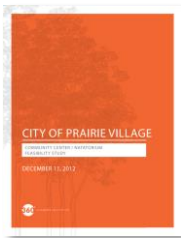

2012



Today

2020 PV Comprehensive Plan

“The Civic Campus is a viable part of the community, and the City will continue to explore opportunities, facilitate its future evolution, and remain committed to considering development of a new community center at the appropriate time.”

Comprehensive Library Master Plan (CLMP)

- CLMP Study completed in 2015 and partially funded by Board of County Commissioners in 2016
- CLMP outlines specific and coordinated vision for Johnson County Library services, facilities, and staffing to inform the next 10-15 years
- Corinth Library Replacement is our next large-scale capital project, as prioritized by the Library Board

Corinth Library History

- Service began in Prairie Village in 1953 via a donated space in the Prairie Village Shopping Center
- The current Corinth Library opened its doors in February 1963 – it has been expanded twice since then
- Corinth houses roughly 107,000 items and is home to a well-loved kids area

Process

Joint Site Study

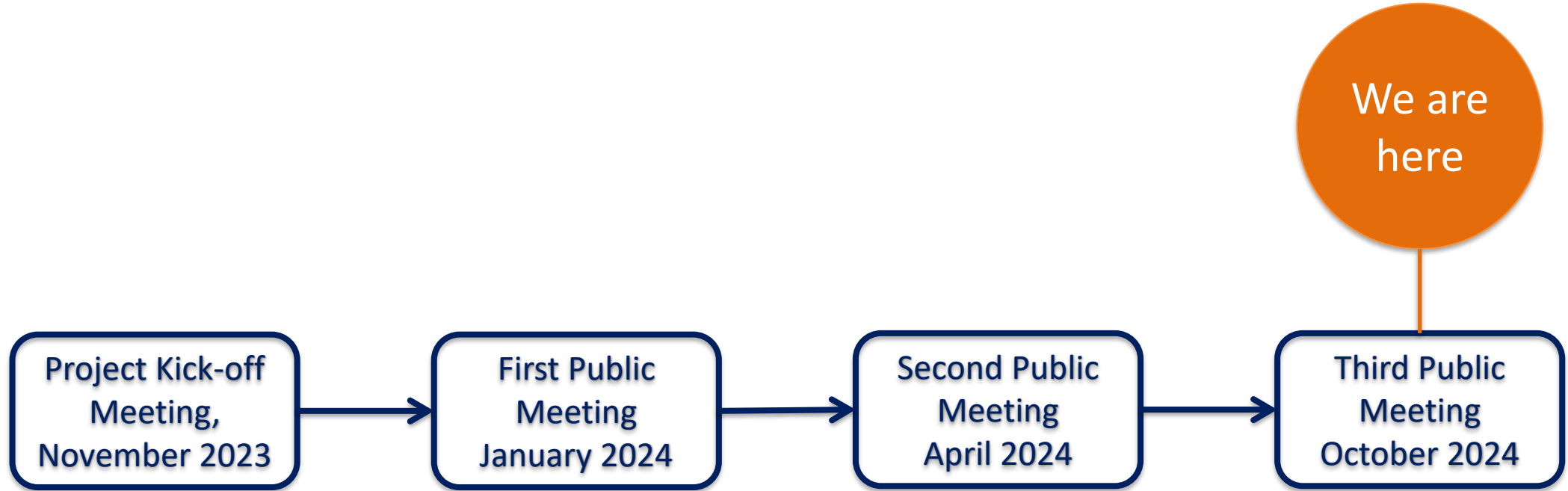



What are your priorities for a potential Community Center Campus Study?

Prairie Village Community Center Campus PUBLIC MEETING

Drop in anytime from 4-7 p.m.
 Thursday, January 25, 2024
 Meadowbrook Park Clubhouse
 9101 Nall Ave., Prairie Village, KS 66207

www.pvkansas.com/communitycenter

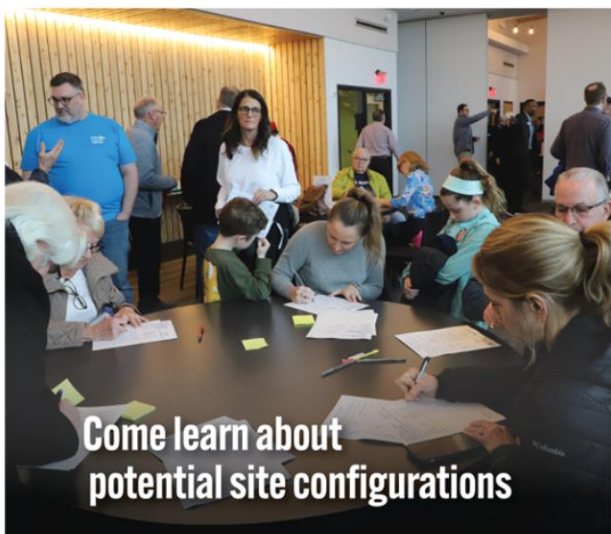

Come learn about potential site configurations

Prairie Village Community Center Campus PUBLIC MEETING

Drop in anytime from 4-7 p.m.
 Thursday, April 4, 2024
 Meadowbrook Park Clubhouse
 9101 Nall Ave., Prairie Village, KS 66207

www.pvkansas.com/communitycenter



The Prairie Village

VOICE

Jan/Feb
2024



Inside this Issue

- 2 Elected officials
Mayor's message
- 3 Upcoming events
Holiday tree drop-off
Council Members sworn in
MLK event
- 4 Arts Council calendar
Arbor Day nominees
Citizen's Academy
- 5 2024 grant programs
Staff spotlight
- 6-7 Trash & recycling information
- 8 Meet your neighbor
Snow safety
- 9 Pet licensing
Holiday tree lighting
- 10 Shop with a PV cop
- 11 Property tax rebate
- 12 Mission Road update
And more!

Prairie Village community center campus study moves forward

The City of Prairie Village, in partnership with the YMCA of Greater Kansas City and Johnson County Library, is moving into the next phase of a multi-year study of a new Community Center Campus in Harmon Park.

This study creates an opportunity to replace the aging Paul Henson Family YMCA with a new facility, operated and programmed by the Y. The study will consider the existing YMCA parcel, as well as sites close to existing amenities like the aquatic center, skate park and municipal buildings. Johnson County Library is

also part of this creative partnership as it considers alternatives for a new branch to replace its Corinth location.

The Prairie Village community is invited to hear more about this study and provide input at a public meeting scheduled for 4-7 p.m. on Thursday, January 25, at the Meadowbrook Park Clubhouse, 9101 Nall Ave. Two additional public meetings will follow.

For more information about the study, public meetings, and engagement opportunities, visit www.pvkansas.com/communitycenter.

Process
Community Meeting One

300 in-person attendees,
with 92 completed
feedback forms. 1058
online forms were
received.

Engagement with project
team members and
conversations about the
possibilities.







Healthy Living
Individual Wellness Goals, Strength Training, Walking Clubs, Personal Training

Health Living
Group Exercise Classes, Self-Defense, Tai Chi, Yoga, Pilates, Weight Loss Classes, Personal Training

Youth Development
Recreation and Outdoors, Family Time, Kids' Night Out, Sports, Art, Reading, Sewing Lessons

Youth Development
Recreation and Outdoors, Summer Day Camp, Teen Work, Coding, Art, Sewing, Recycling, Gardening

Indoor Aquatics
Swimming, Water Aerobics, Water Polo, Water Skiing, Lifeguarding, CPR/AED Training, Aquatics Training

Community Spaces
Meeting Rooms, Gatherings and Social Spaces, Conferences

Social Responsibility
Financial Assistance for Membership and Programs, Food Contribution for Hunger Prevention, Blood Drive, 2000+ Annual Classes, English as a Second Language, Volunteer Opportunities

Typical Community Center Amenities
The Johnson County Library Center for the Arts, Bookmobile, Senior Center, Music Studio, and more. The center also has a community room, meeting room, and a large open area for events. The center is open to the public and is a great place to meet and connect with your neighbors. Community spaces make a difference in the lives of our residents. Social Responsibility and Aquatics are also offered at the center. The center is a great place to meet and connect with your neighbors.

Additional Elements
What other spaces or amenities would you like to see at the community center? (NEAT)

Campus site study area



- PROS AND CONS**
- | | | |
|---|---|--|
| <ul style="list-style-type: none"> • New City Ball Courts • Visual connection • 2nd floor playground • Lighting | <ul style="list-style-type: none"> • Parking • New building • Community gathering • The drive in • Water line supply | <ul style="list-style-type: none"> • Use of all roads • Shared parking • Shared parking • Shared parking • Shared parking • Shared parking |
|---|---|--|

Two campus sites appear viable. Further study of both sites will occur prior to the next community meeting.

Co-locating the Community Center YMCA and the Library provides benefits such as:

- Creates campus plaza between facilities
- Shared parking and drop-off / pick-up
- A gateway entrance to Harmon Park
- Shared outdoor public realm
- Convenience
- Shared programming



Potential campus plaza amenities between library and community center

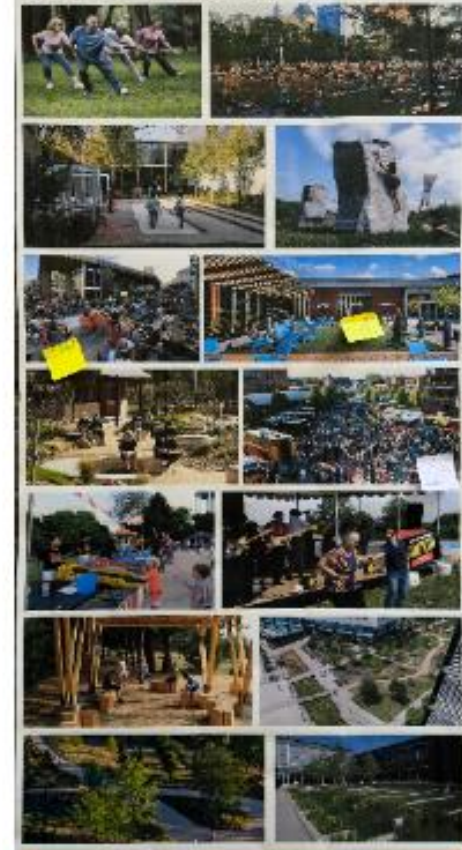

What **EXCITES** you about a potential campus with both facilities co-located?



What **CONCERNS** you about a potential campus with both facilities co-located?



Community Center Campus Benefits

- Creates a campus plaza between facilities.
- A home for city traditions.
- A gateway entrance to Harmon Park.
- Shared outdoor public realm (placemaking.)
- Shared parking and drop-off/pick-up.
- Shared programming and resources.
- Convenience



Process
Community Meeting Two







Process

What we heard

Prairie Village Community Center Campus
PUBLIC MEETING #2 QUESTIONNAIRE

Please Identify one preferred option.

Option A
 Community Center and Library co-located at the southwest portion of Harmon Park.



Option B
 Community Center and Library co-located at the northwest portion of Harmon Park.



Option C
 Community Center Co-located at the northwest portion of Harmon Park. Corinth Library replacement located elsewhere.



Option D
 No site changes. Existing YMCA may continue to operate. Corinth Library replacement located elsewhere.



Why is this your preferred option? Please select all that apply.

- Best use of land
- Proximity to other park amenities
- Ease of access
- Parking
- Minimizes impacts to existing park amenities
- Co-location of Library and Community Center YMCA
- I want the YMCA to remain in PV
- I want the Library to remain in PV
- Proximity of YMCA to existing pools
- Parking garage
- No parking garage
- Traffic impacts
- Project not needed
- Not a good use of funds
- Other _____

Zip Code: _____
 Name (optional) _____
 Email (optional) _____



Public Engagement

- 280 attendees, with 520 total questionnaire responses (in-person and online.)
- Initial support at the first public meeting showed 48% positive, 30% neutral, and 22% negative public sentiment about the project.
- After the second public meeting, 74% of people selected one of the three new Community Center options, and 26% of people selected option D.

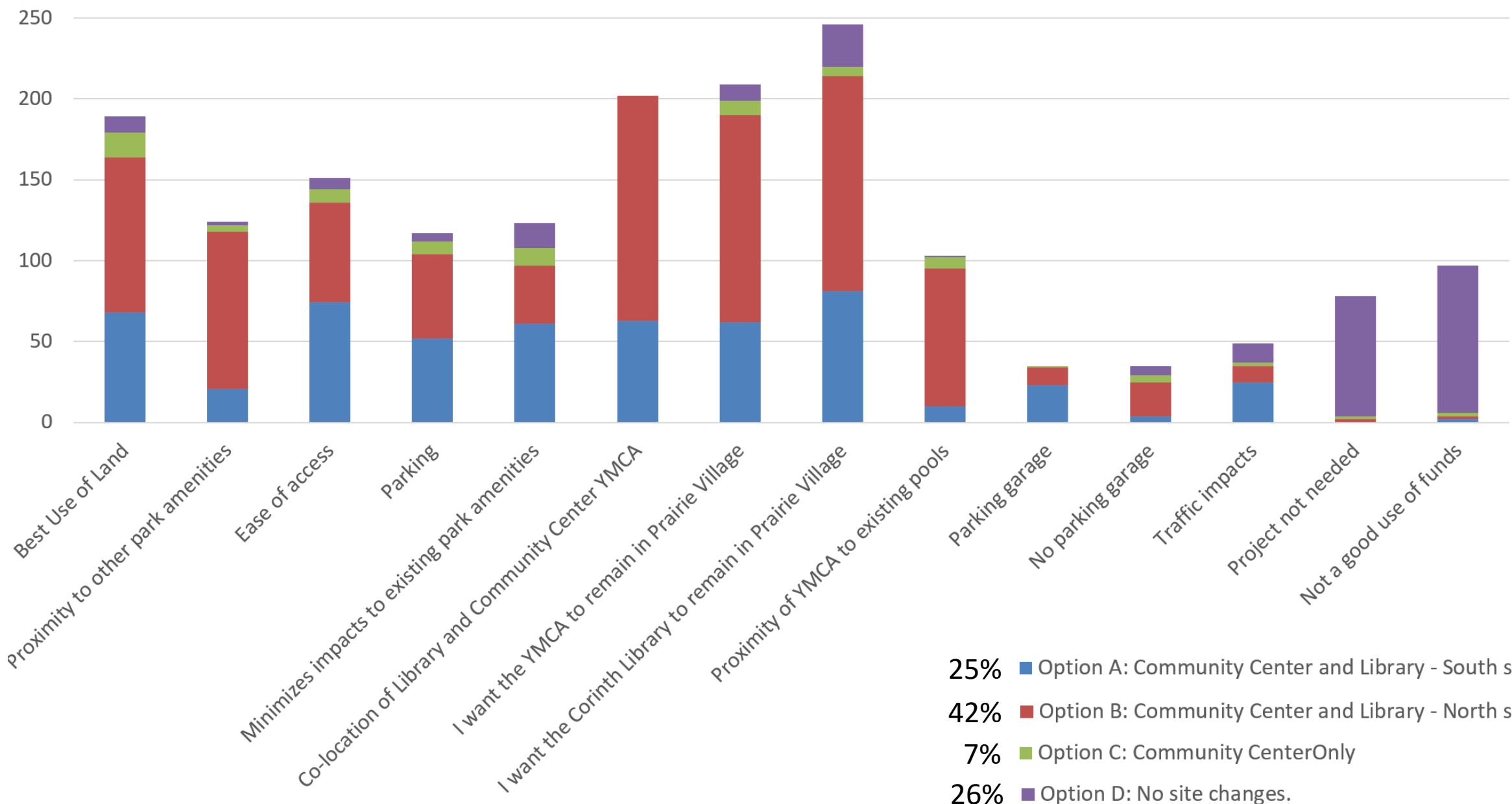

- 25% ■ Option A: Community Center and Library - South site
- 42% ■ Option B: Community Center and Library - North site
- 7% ■ Option C: Community Center Only
- 26% ■ Option D: No site changes.

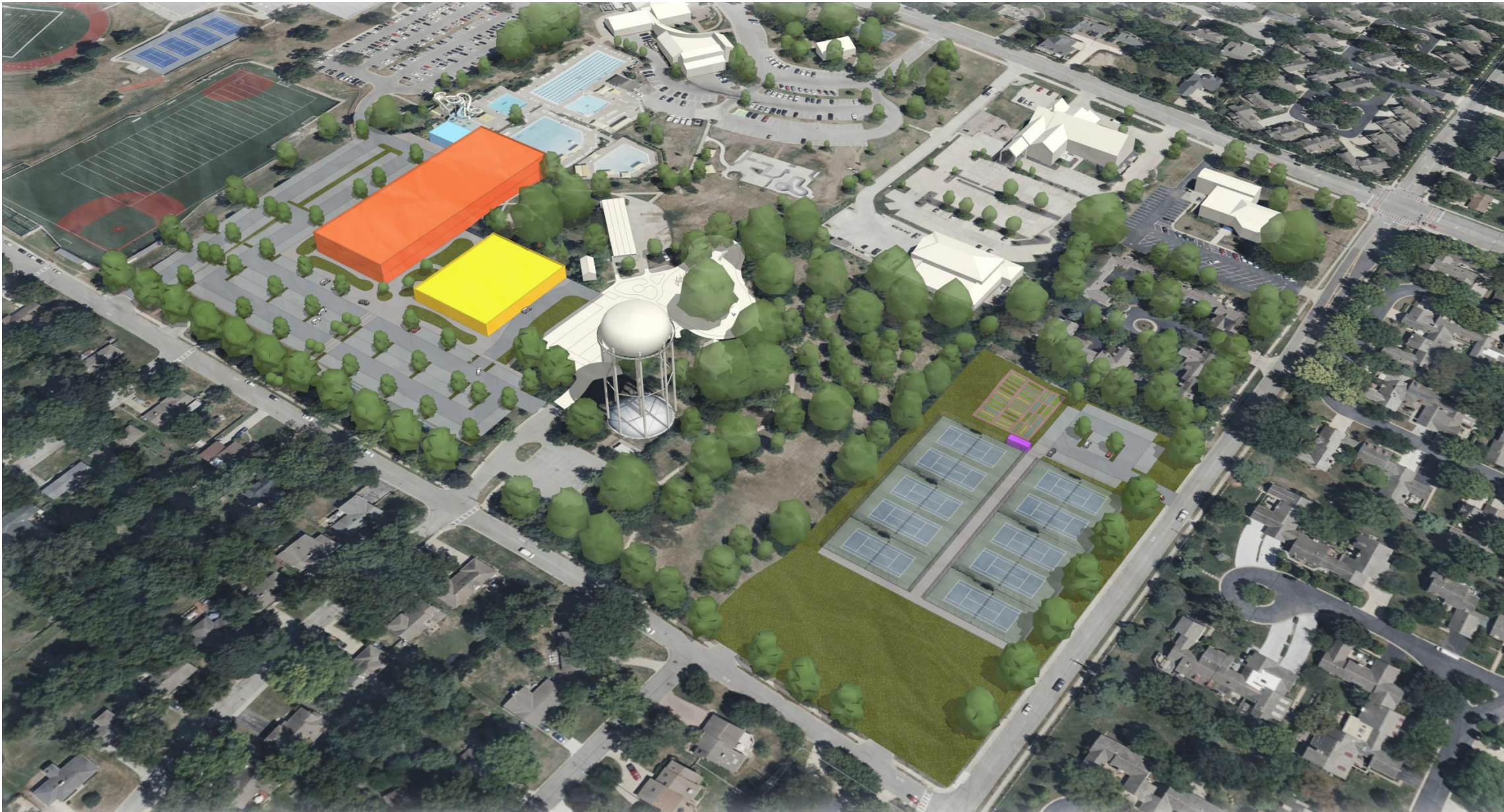

Library Funding

Library Funding

- Library is already funded through the CLMP – we are not a part of any additional PV tax
- We are concurrently performing a test-fit study of our existing Corinth site
- Library staff are presenting to the Library Board regarding pros and cons of both site options

Community Center Cost

Community Center and Park Funding

- Project cost for the Community Center, including 10 acres of site development, new outdoor aquatic pool house, and the relocation of the tennis courts is \$55,341,099 projected in 2026.
- If the project moves forward, it would be funded by a 5/8 to 3/4 percent sales tax increase.
- Agreements with YMCA and Library continue to be negotiated.

Concept Design

Site relationships

Site Organization

Relocated Tennis Courts and Community Garden
New Pool Entry Building
Community Center, Library, and Shared Plaza
Generous Parking
Roughly 10 acres of site development.

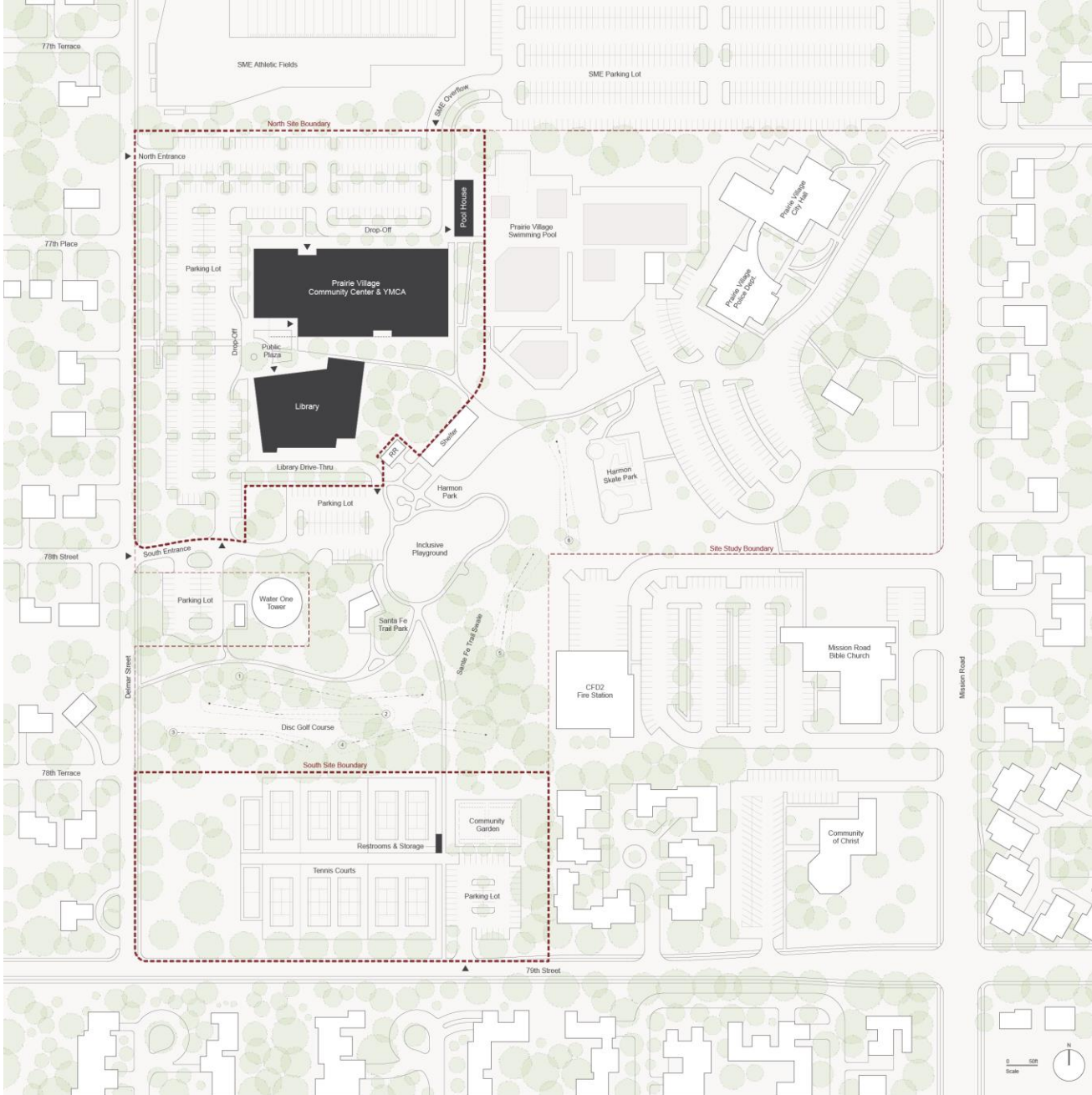

South Parcel

Relocated Tennis Courts and Community Garden
Restrooms and Storage Building
Adding 4.25 acres to the park

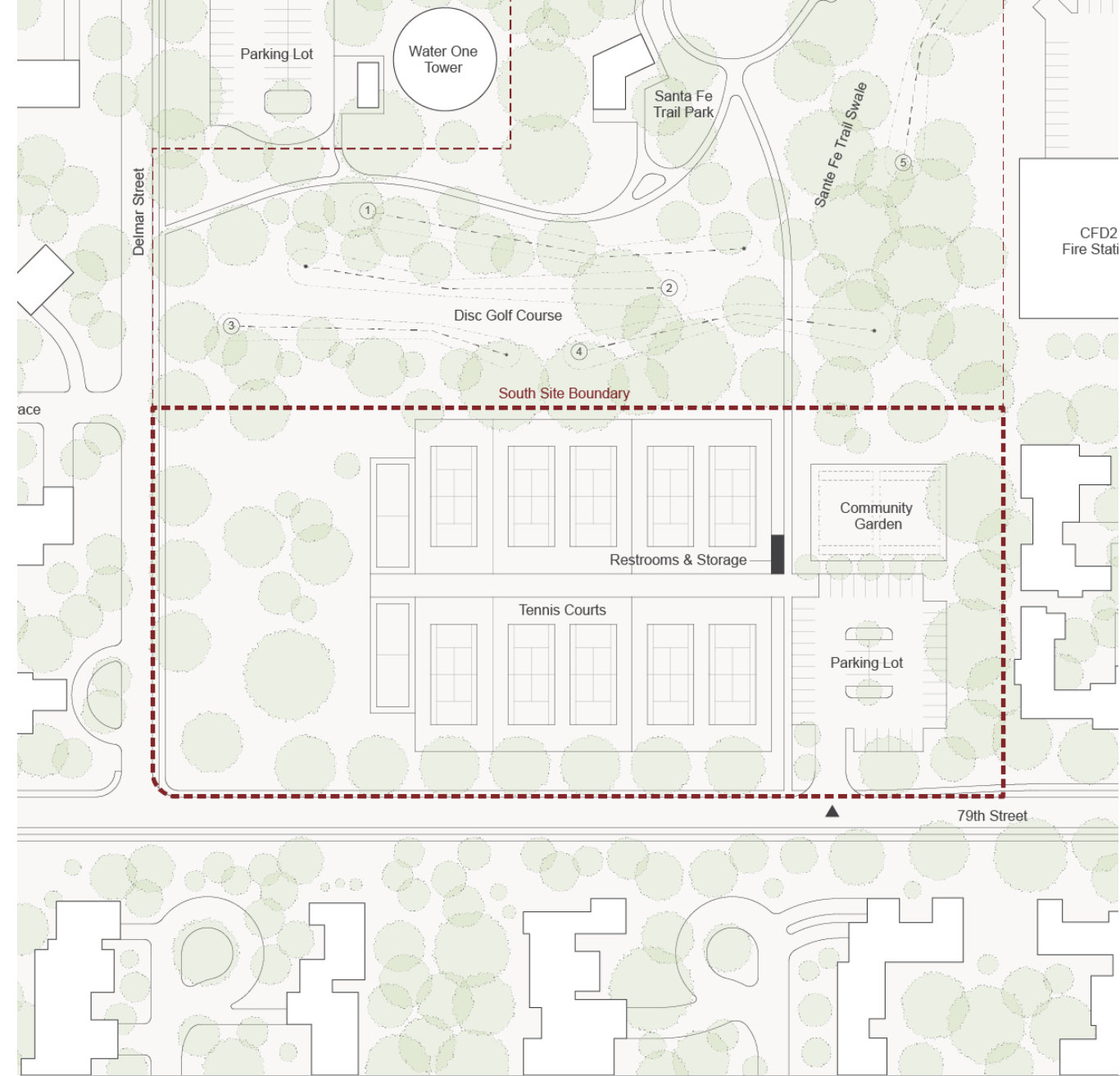

Vehicular Connectivity

Welcoming from all approaches
Safe interaction with all road users
Generous drop-off zones
Keeping parking out of the park.

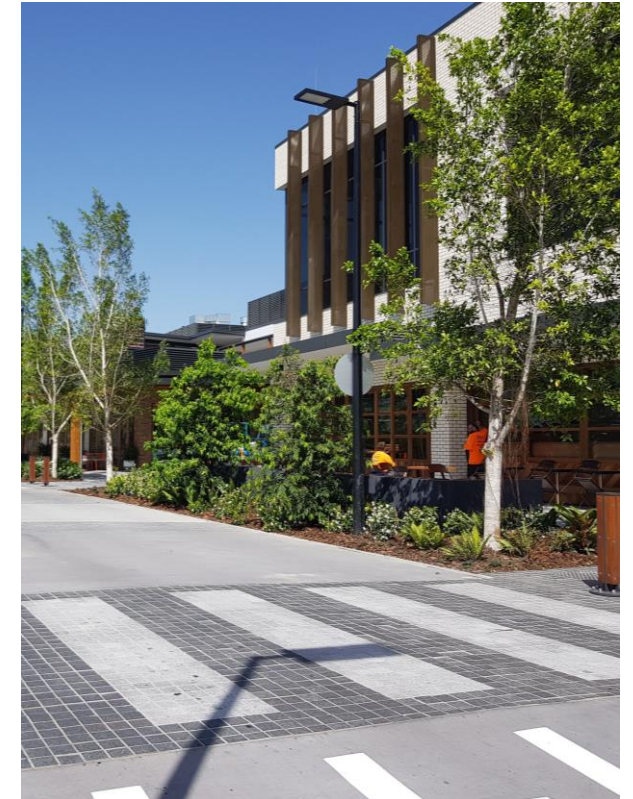
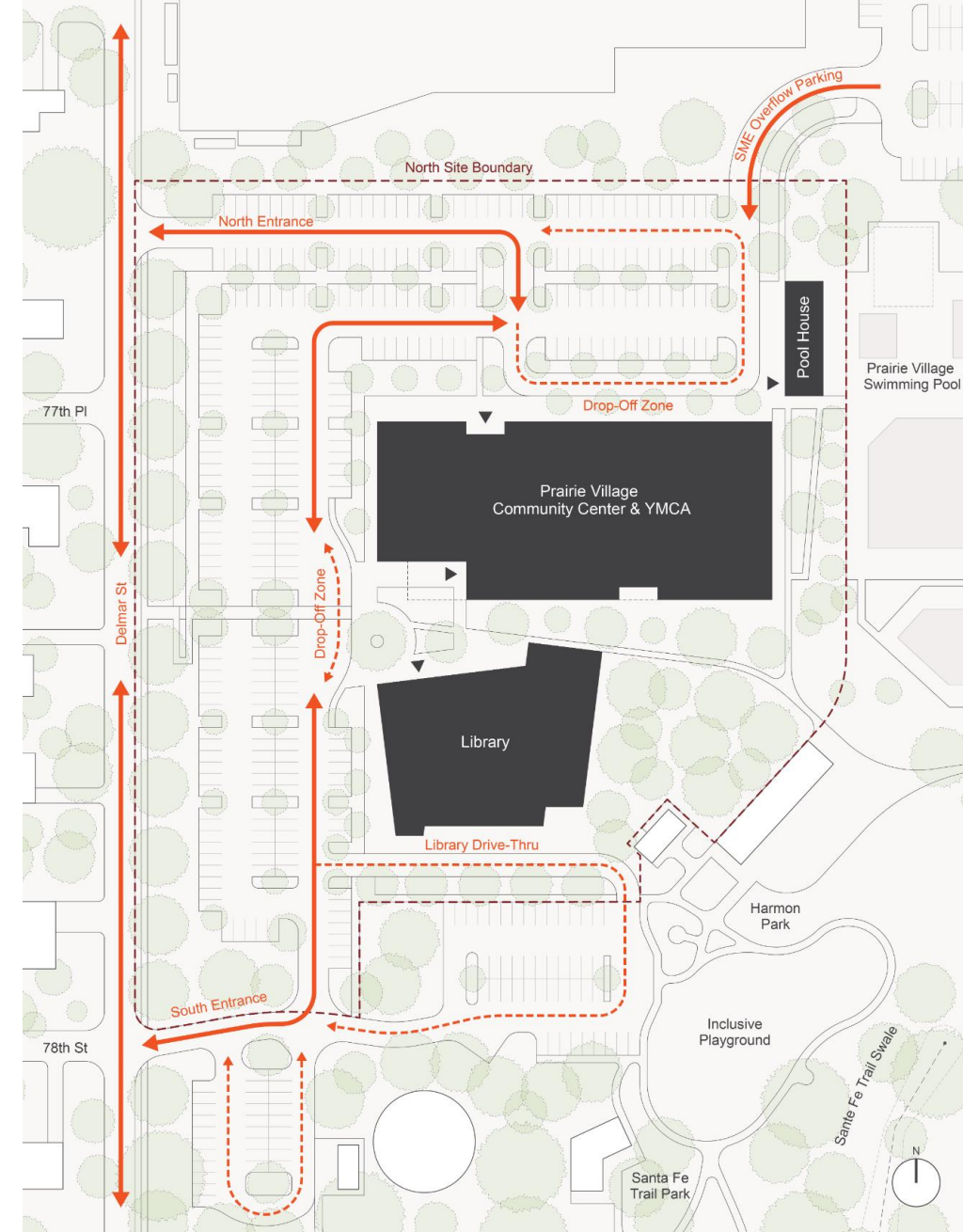

Pedestrian Connectivity

Welcoming from all approaches

Safe interaction with all road users

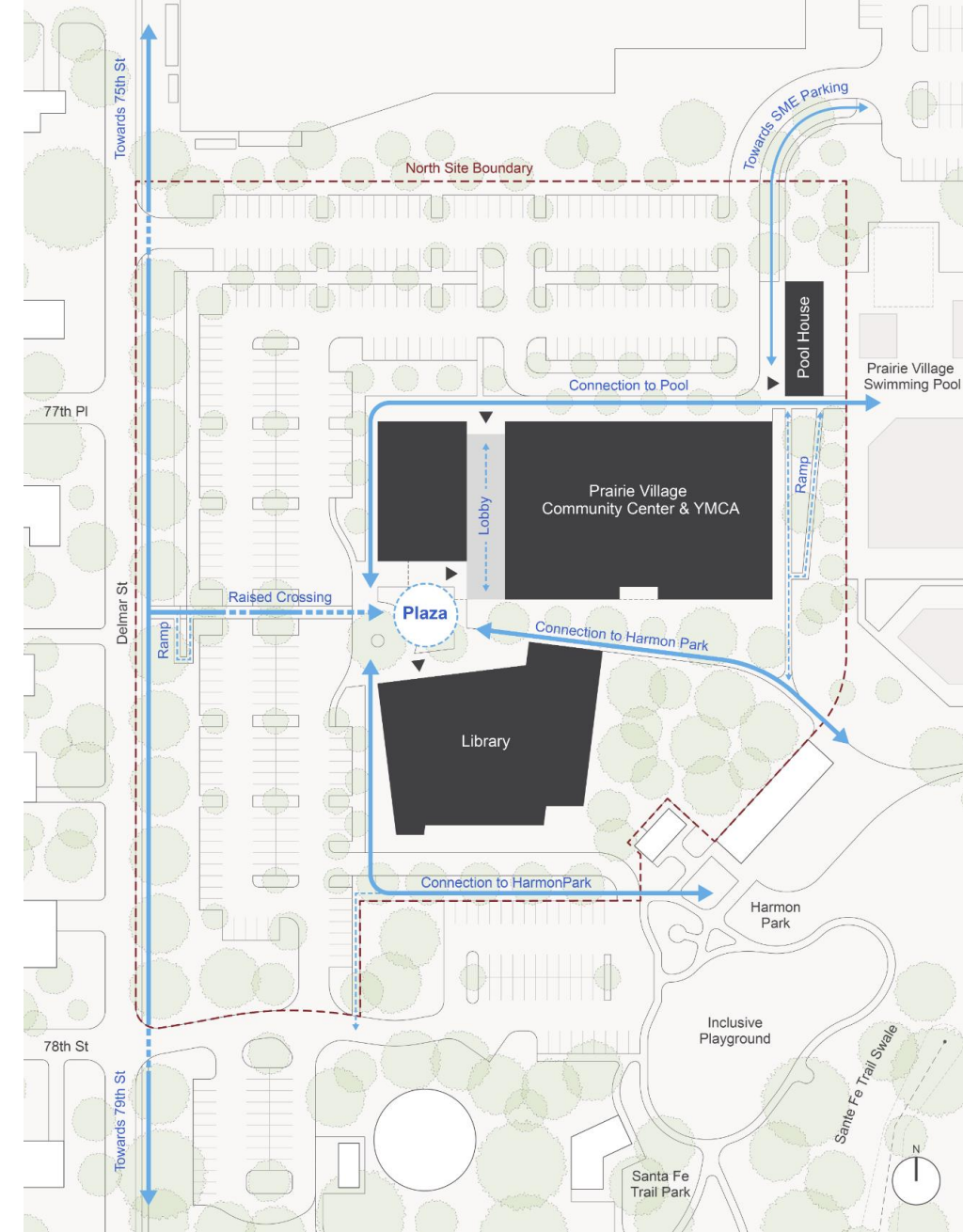
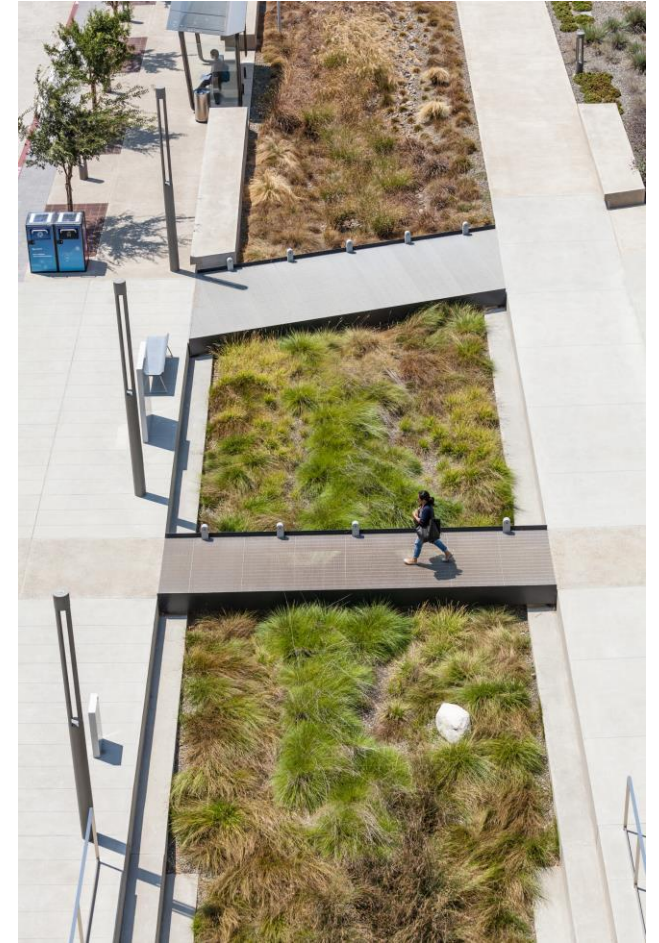

Landscape

Landscaped procession to pavilion.
Landscape buffer from neighborhood.
Greenspace connectivity

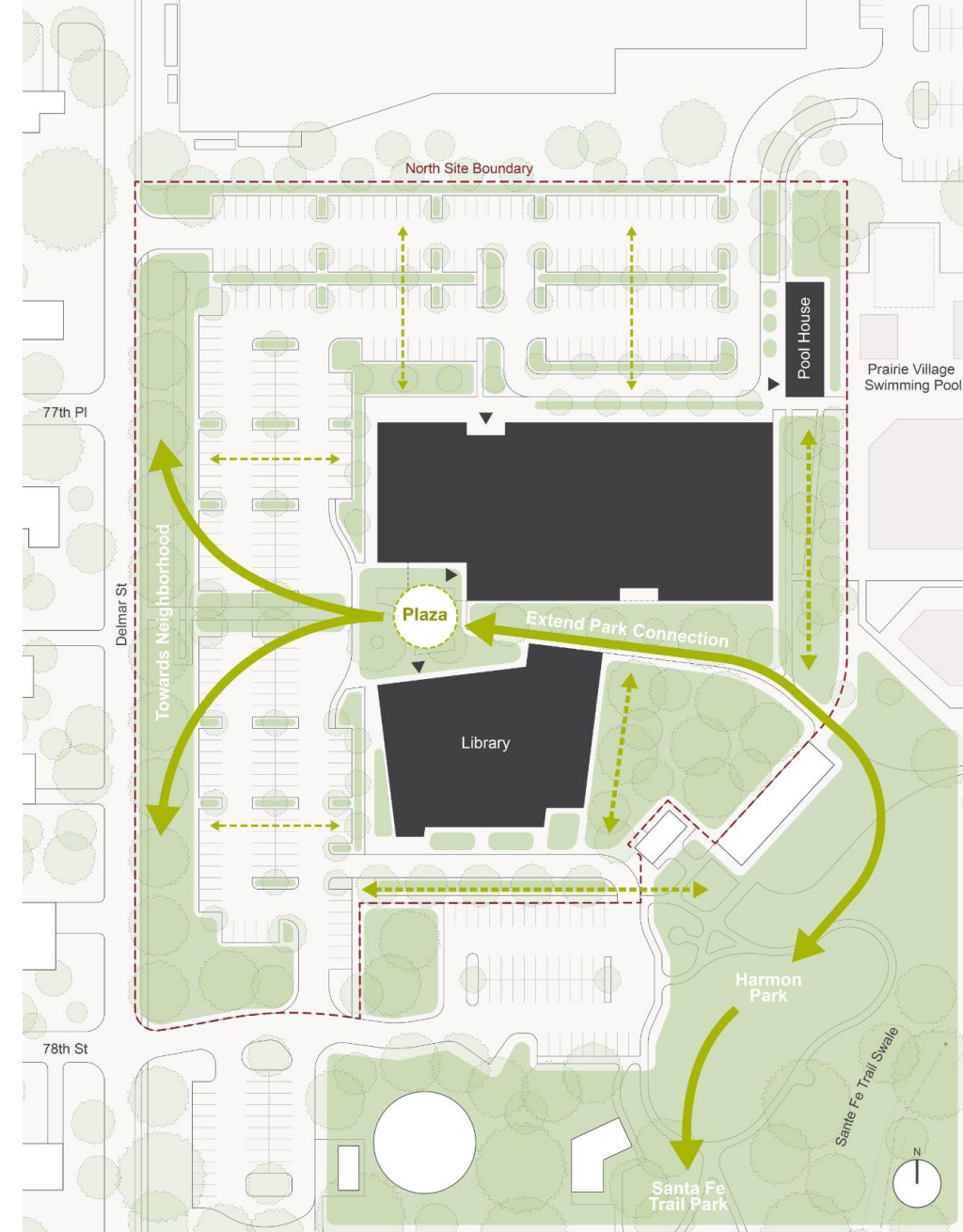
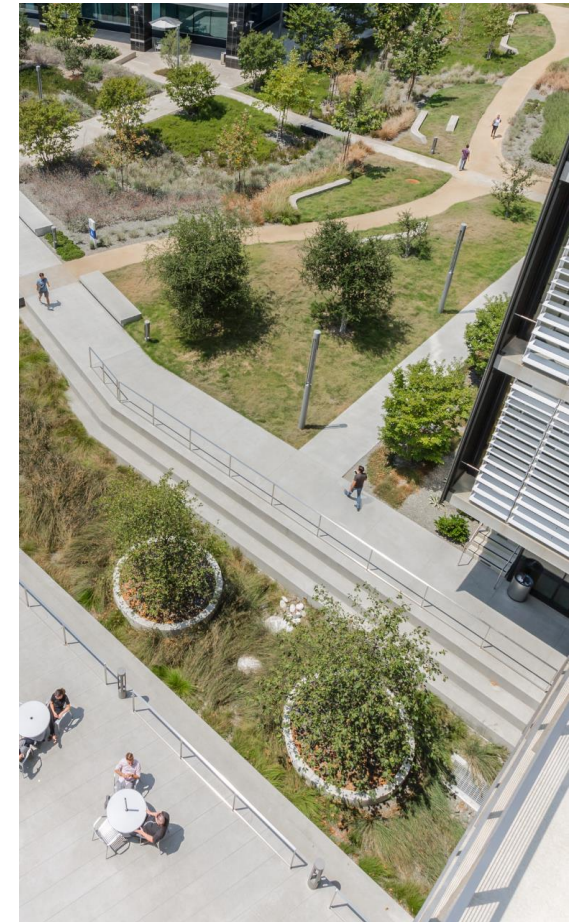

Concept Design
Community Center Building Organization

Building Organization

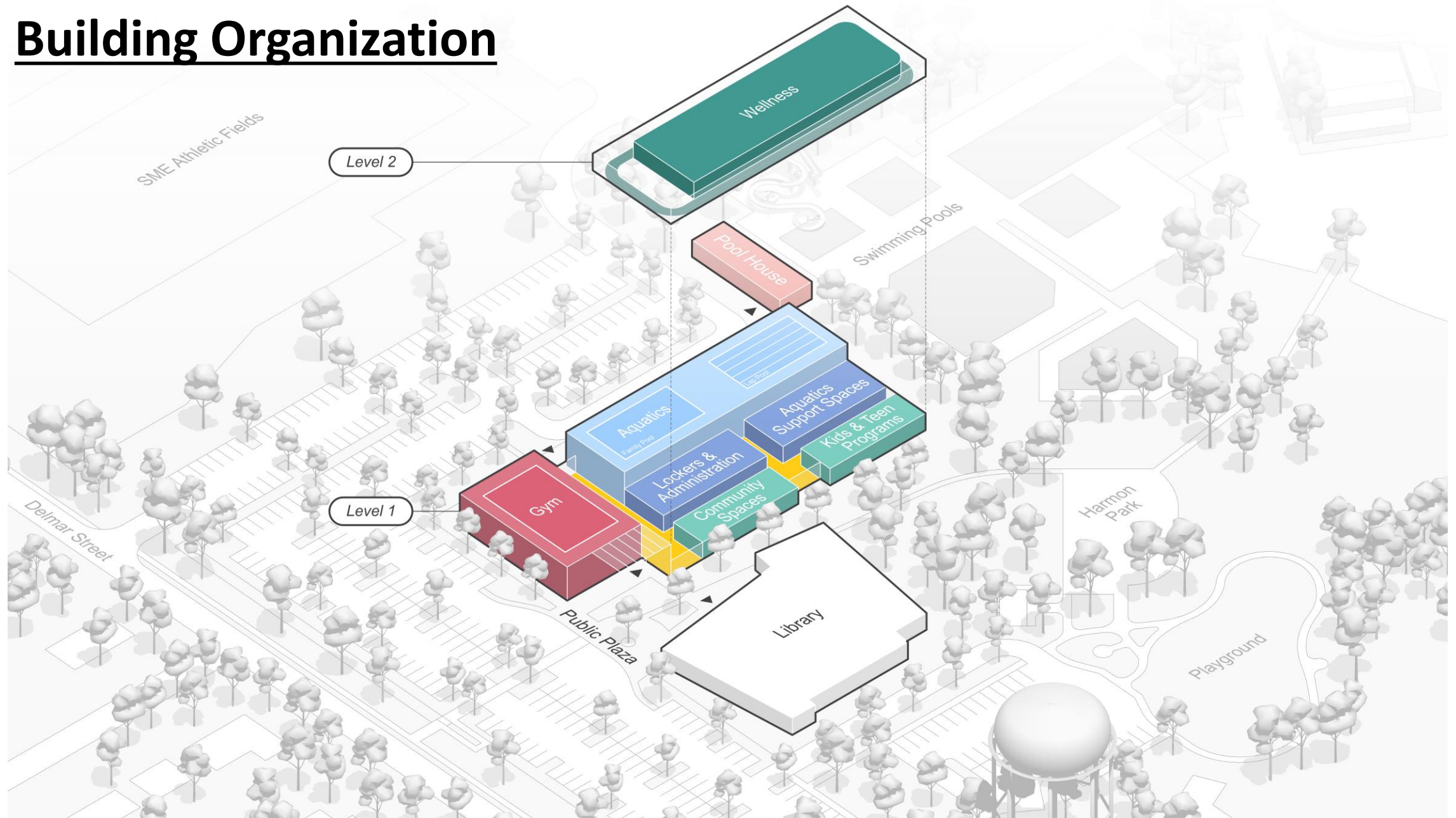

Gymnasium

One 6,600 square foot multipurpose court (94' x 50' high school basketball court,) striped for basketball, volleyball, and pickleball.

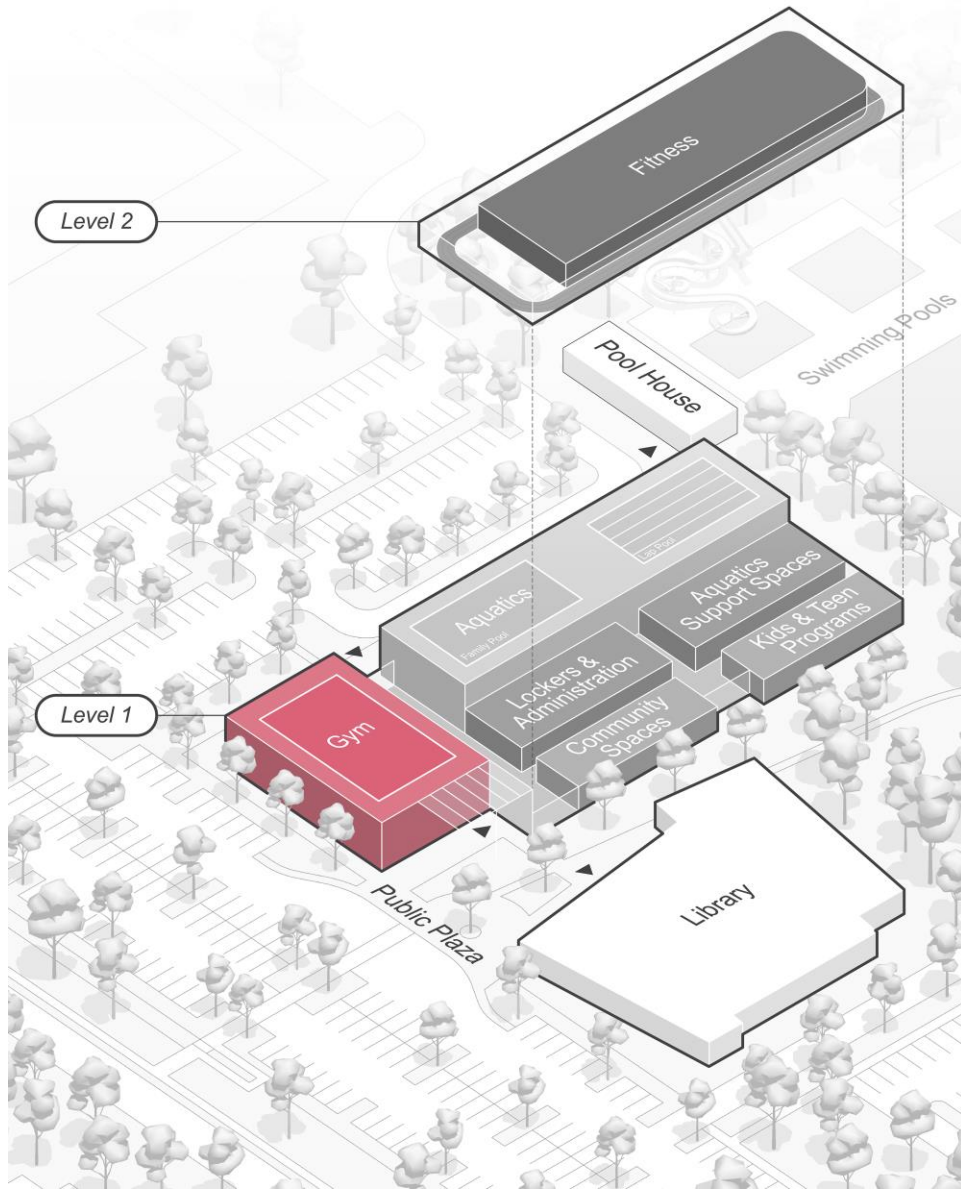

Look and Feel Precedent Imagery

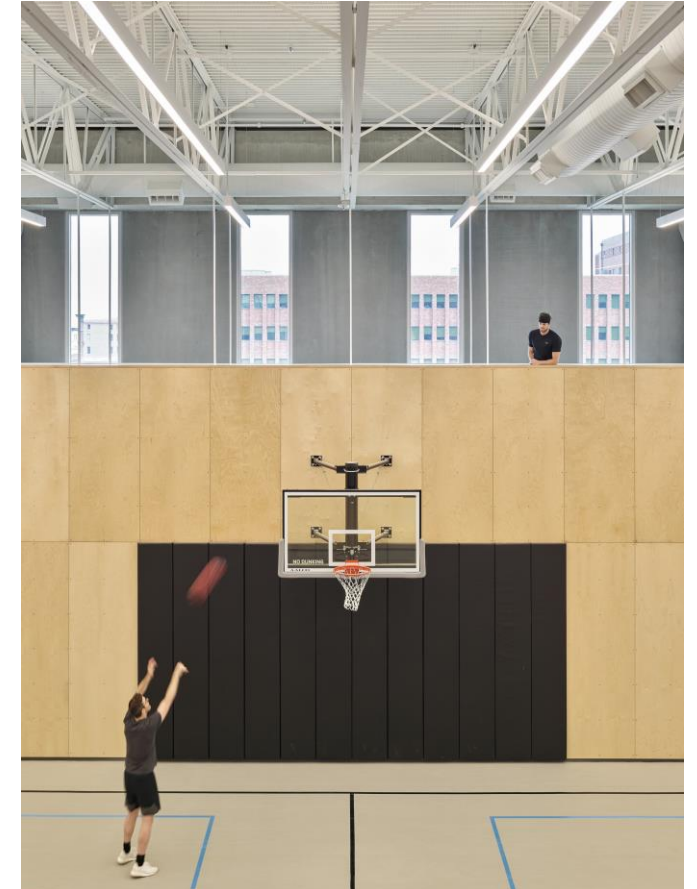

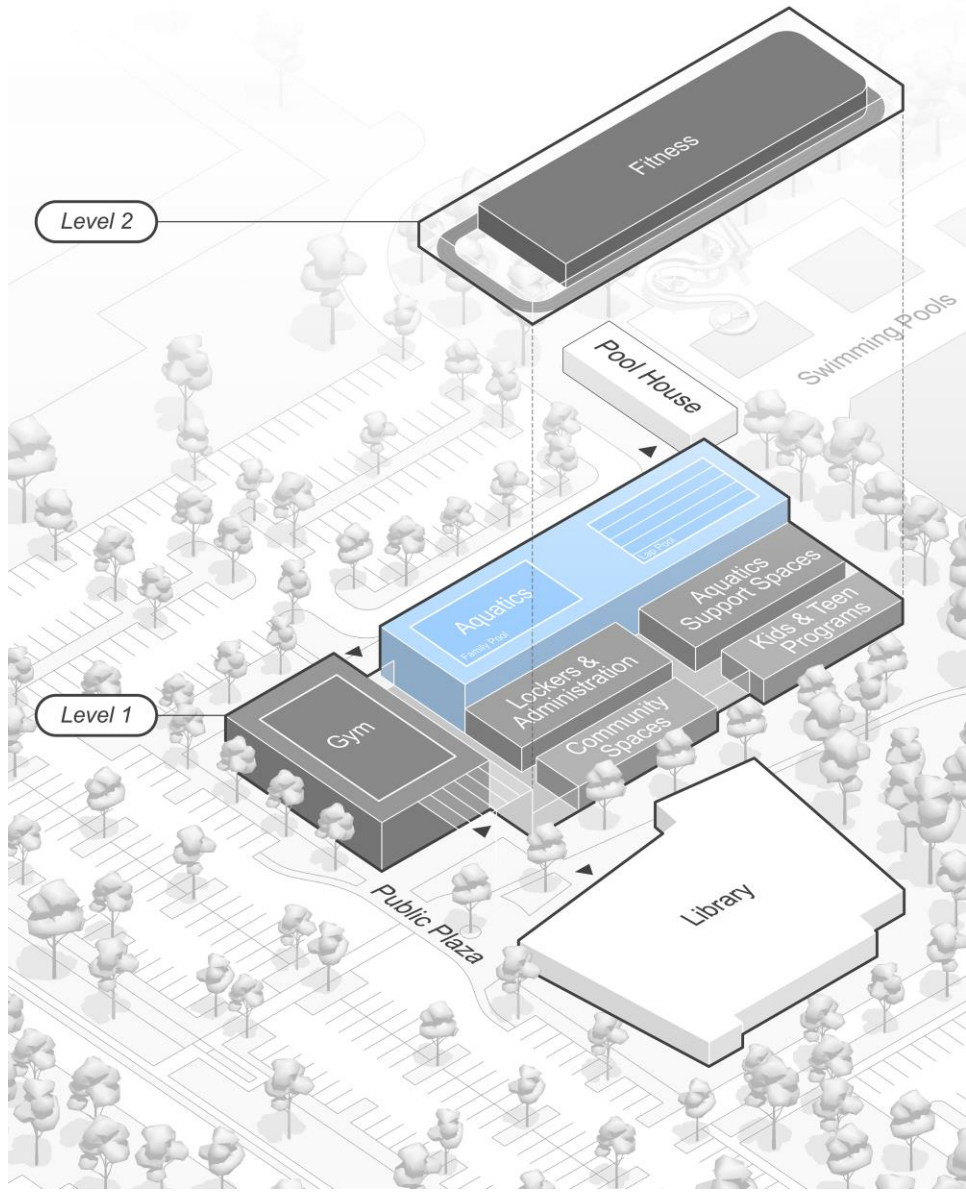

Indoor Aquatics

Recreation pool, five-lane 25 yard lap pool, Steam, Sauna, and Whirlpool
 Visibility from North and public lobby
 North Daylight for reduced glare.



Look and Feel Precedent Imagery

Outdoor Aquatics

New pool house for the outdoor pool complex.
Entry and ticketing, Restrooms, Concessions.

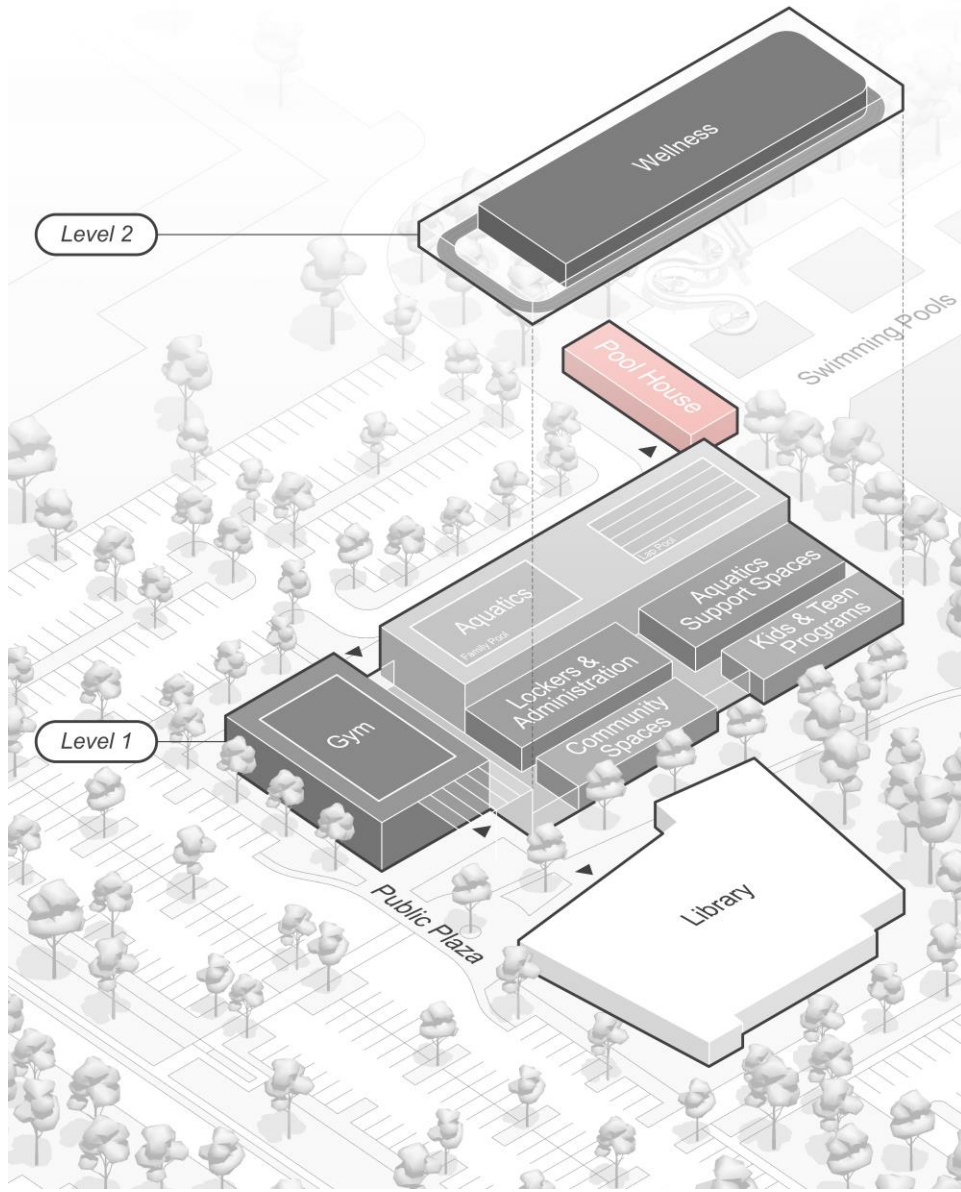

Look and Feel Precedent Imagery

Public Commons

Welcome center, civic living room and gathering space.
A space for all ages.

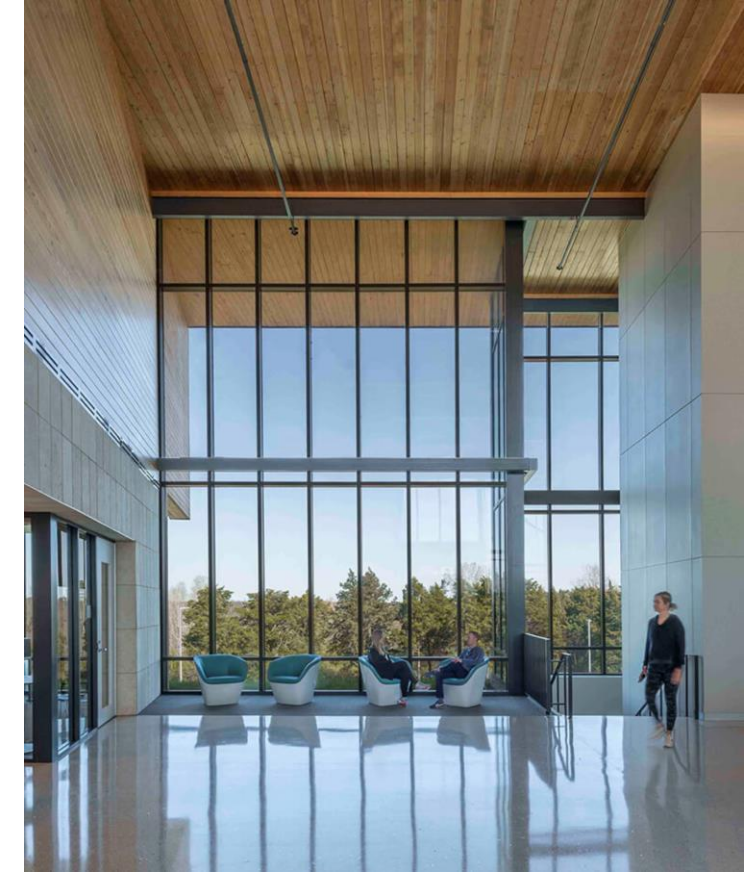
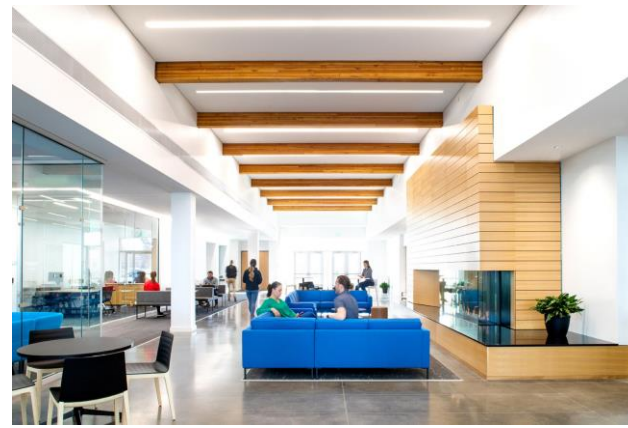
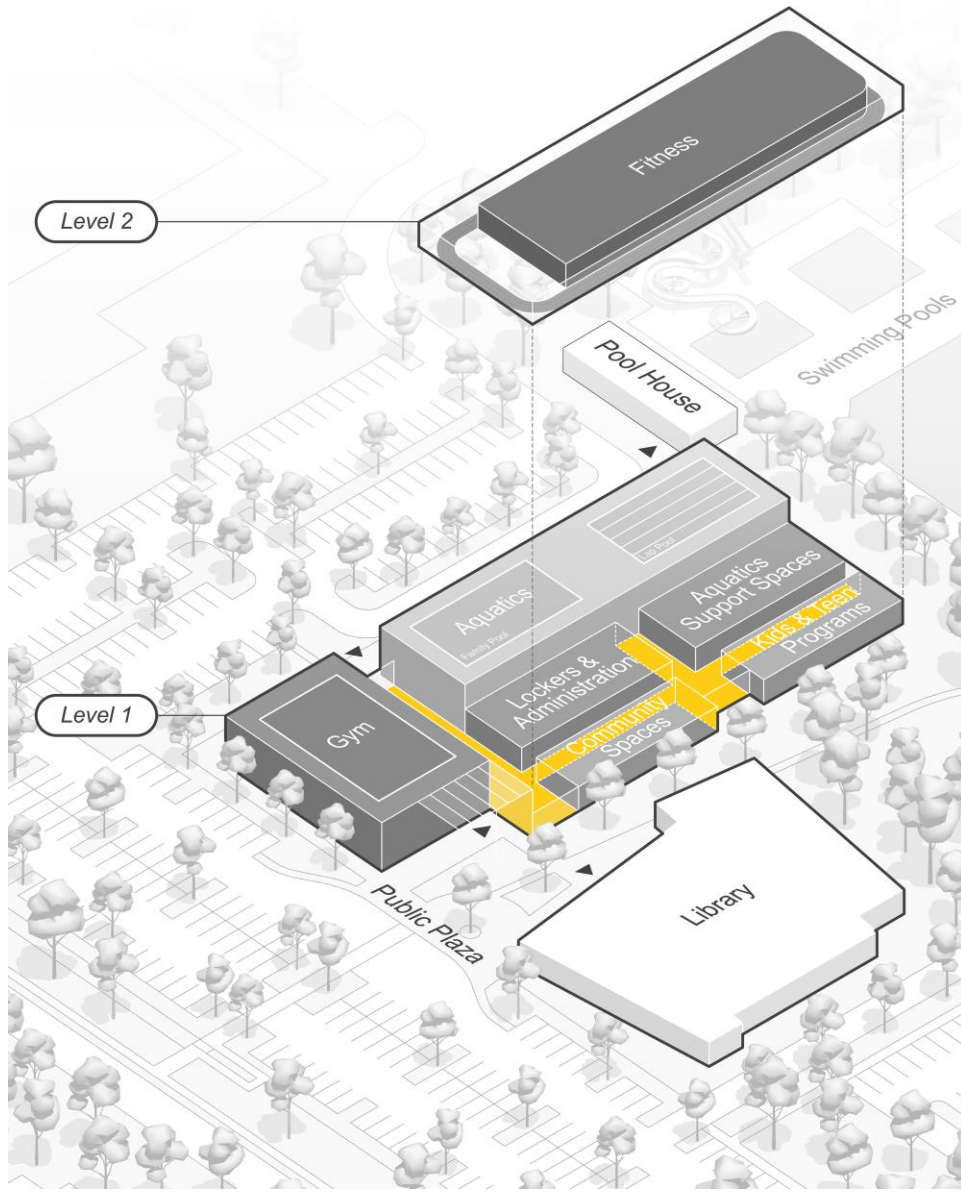

Look and Feel Precedent Imagery

Community Meeting Rooms

Two community meeting rooms that can be combined.
South exposure with visual access to park.
Adjacent to public plaza and main entry
2000 square feet, 133 occupants.

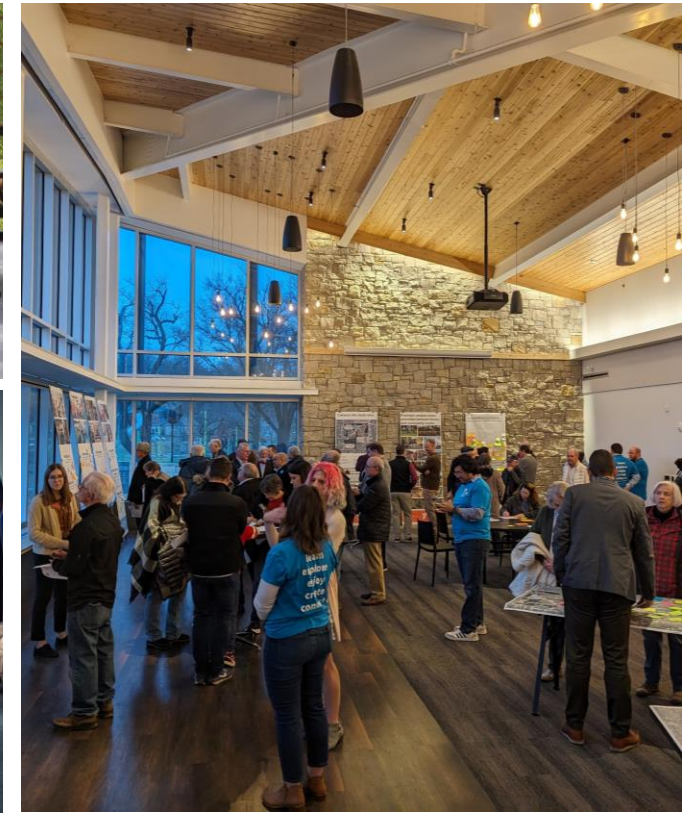
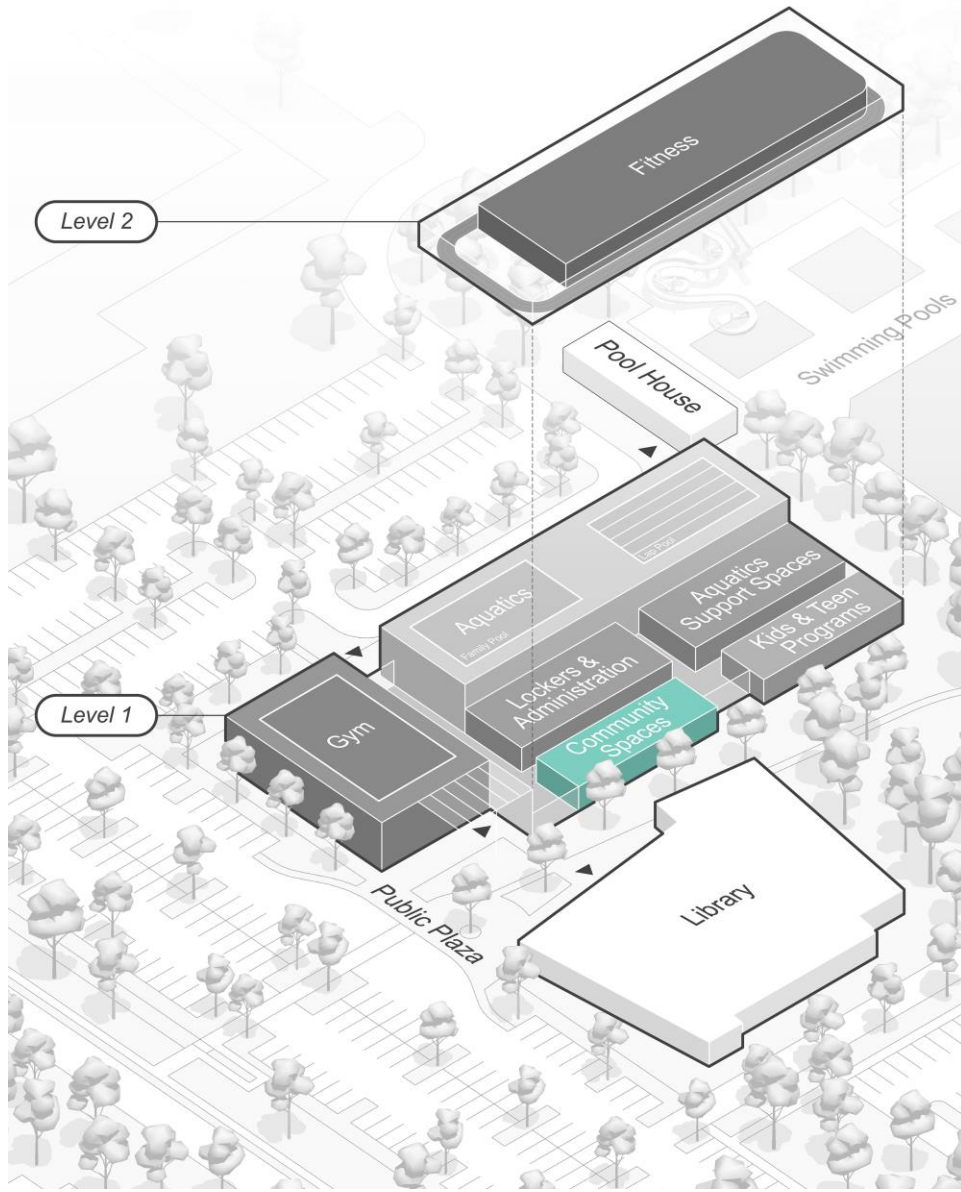

Look and Feel Precedent Imagery

Youth Spaces

KidZone drop-in childcare.
TeenZone hangout room.
Safe spaces for all ages.

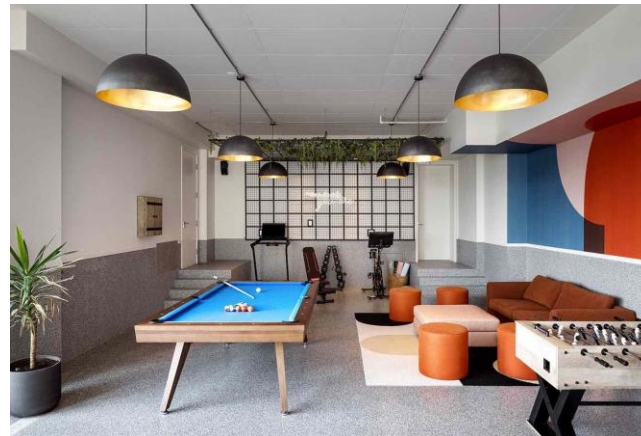
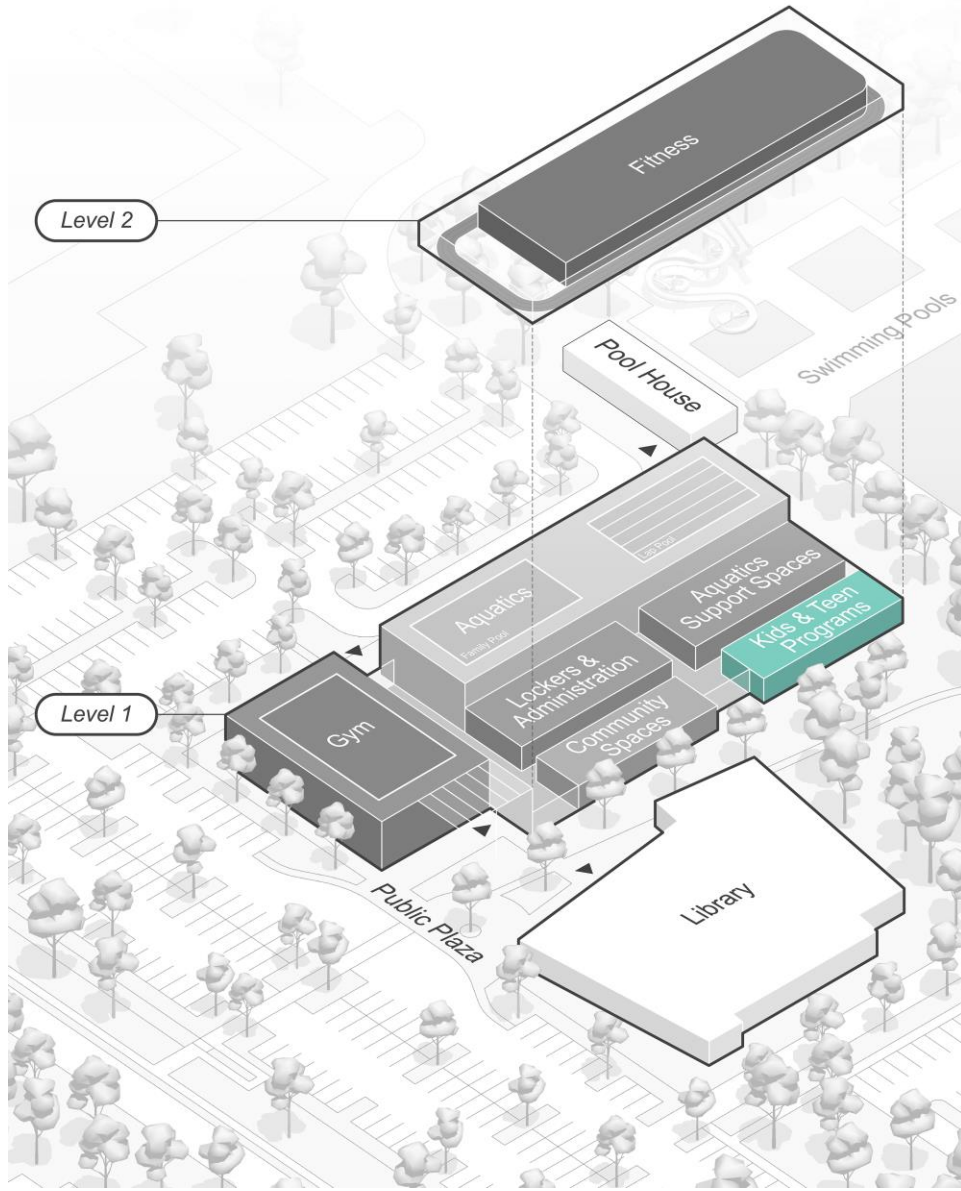

Look and Feel Precedent Imagery

Aquatic Support

Birthday party rooms
Steam, Sauna, Whirlpool

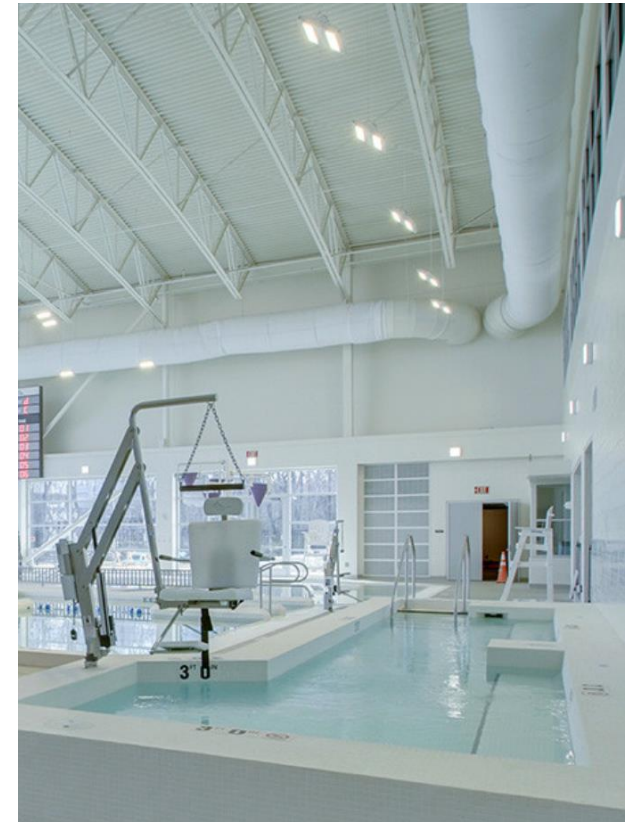
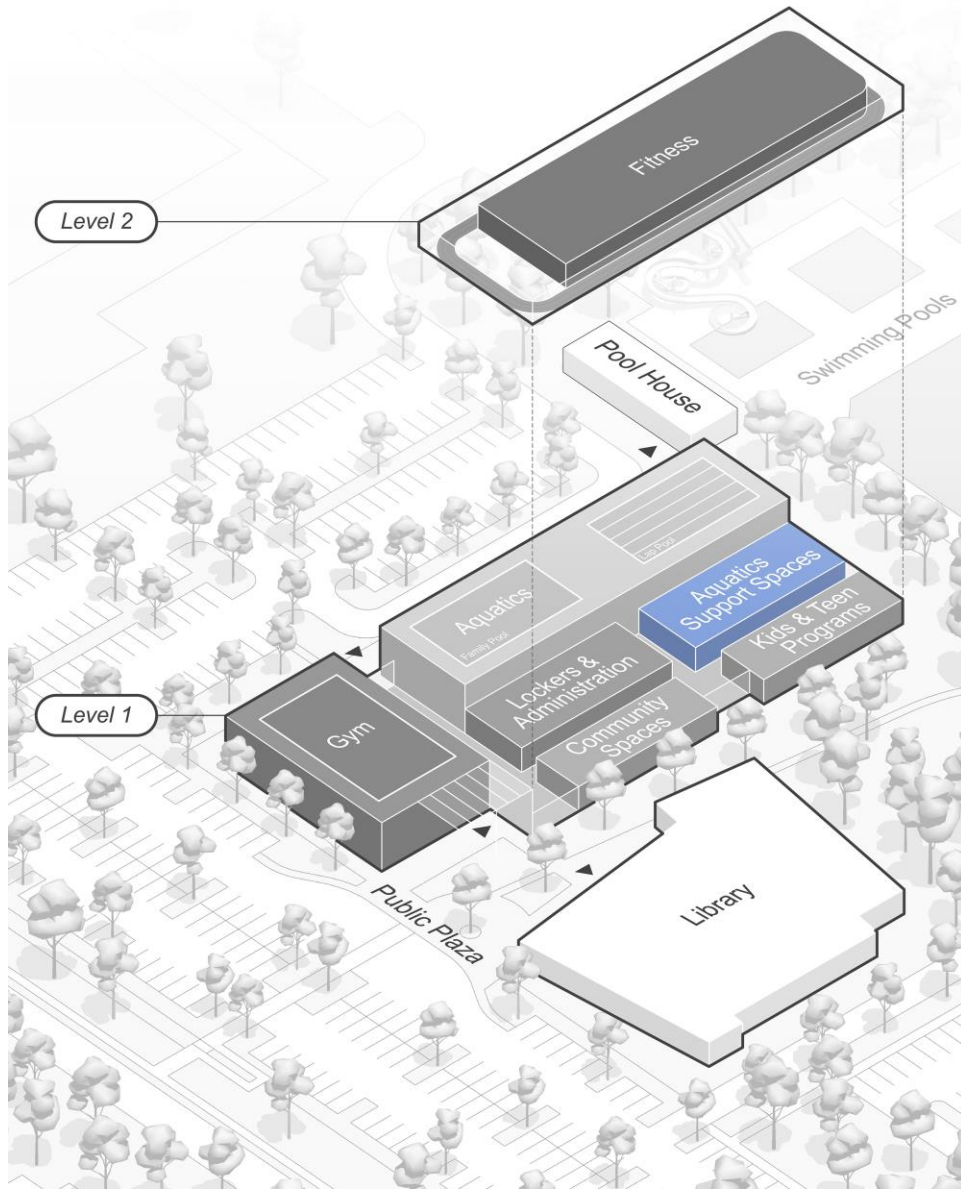

Look and Feel Precedent Imagery

Lockers and Administration

Modern locker configurations

Men's, women's, and family locker rooms.

Wet zones, dry zones, changing rooms, privacy.

Welcome Center

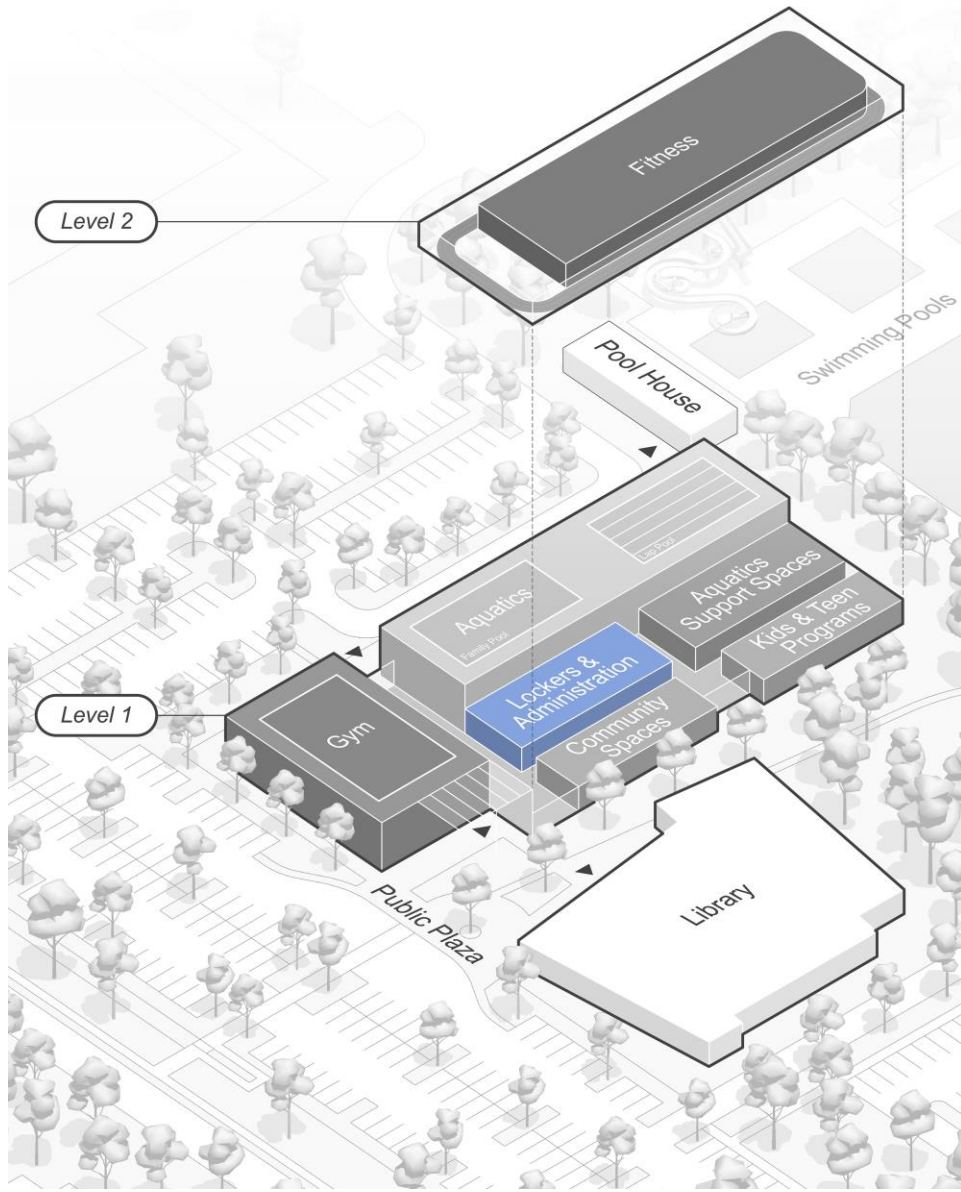

Look and Feel Precedent Imagery

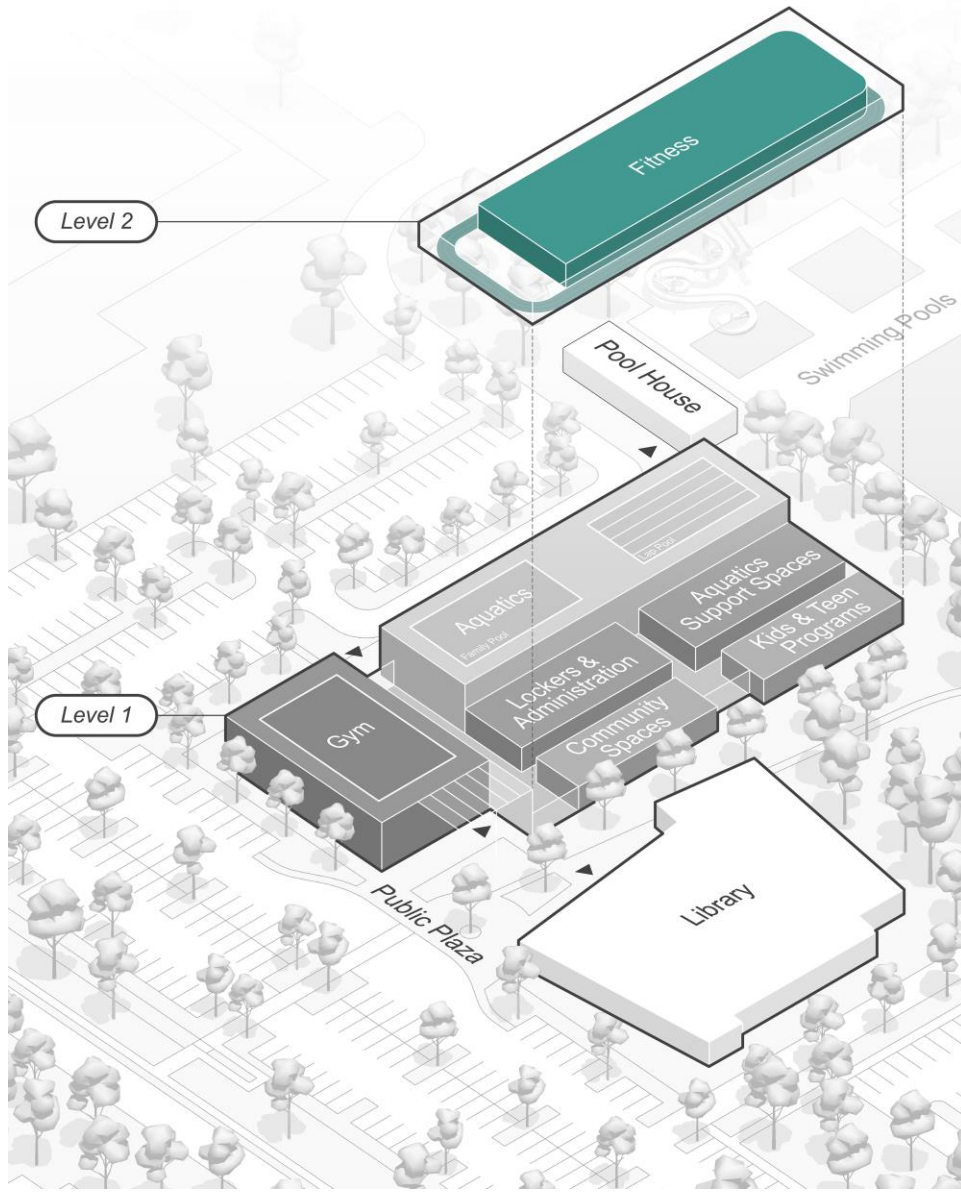

Wellness

Group fitness room, spin studio, weights, cardio, functional training.

Modern equipment.

Indoor track (10 laps/mile)

Consultation Room.

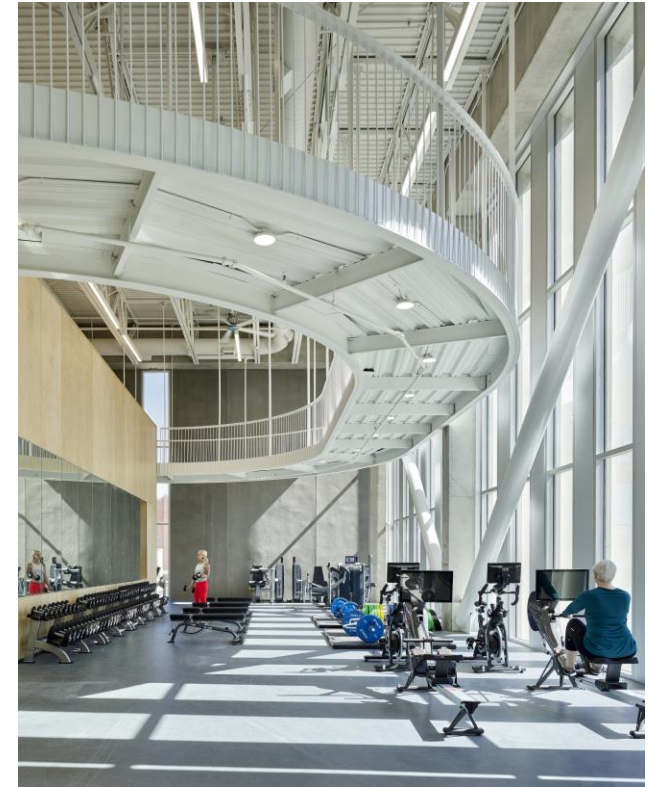

Look and Feel Precedent Imagery

Approach from the North...



Prairie Village Community Center



Next Steps

Community Center Next Steps

- If City Council approves of the general direction, they will put the project to a public vote.
- Anticipated mail in ballot to all PV residents in Spring 2025

Library Next Steps

- The Library Board will provide direction on whether it is desirable for the library to move to the PV campus –in advance of any public vote
- The Library Board and City of PV would need to agree in principle on property transfer terms prior to the Library Board’s decision
- Library acquisition of property would be contingent on both approval from the BOCC and a successful public vote

Call to Action

1. Use the comment cards provided, or the project email address to provide your input to your elected officials, the YMCA, and the Library board.

CommunityCenter@pvkansas.com

2. Reach out to your representatives directly and let them know how you feel about the project. Their contact information is available at *pvkansas.com*

3. Vote

Approach from the North...



Prairie Village Community Center